



PCM 250

Product Information Sheet

Standard Specification

Dimensions

Width/Depth/Height (mm)	645 / 645 / 1570
Inlet diameter (mm)	250
Outlet diameter (mm)	50
Tare weight (kg)	123
Nominal capacity (L)	250

Composition

Tank	Mild Steel
Lining	LLDPE ²
Pallet base	Mild Steel
Closure	SS ¹
Closure gasket	EPDM ³

UN Certification

GP II, SG 1.9

Options

Painted tank and pallet base
 Vinyls on tank
 Label plates on tank
 Outlet valve seal options

- 1 – Stainless Steel
- 2 – Linear Low Density Polyethylene
- 3 – Ethylene Propylene Diene Monomer (rubber compound)
- 4 – High Density Polyethylene
- 5 – Glass Reinforced Polypropylene

General Description

The PCM 250 is a reusable IBC designed for the transportation, storage and pressure discharge of hazardous liquids.

The pressure discharge method is highly cost effective; containers are not left with customers. Instead a unit on average can achieve 3 deliveries a week. The container also comes with a "Safety Air Feed". This enables delivery personnel to discharge the IBC quickly and effectively, whilst safely standing on the ground. The cylindrical tank body, manufactured from mild steel, is inherently much stronger than square tanks and with no crevices is easy to clean down. The tank body can be painted to provide resistance to the external environment. The integral pallet base has two way fork truck and pallet truck entry to improve handling efficiency.

The tank inlet which is 250mm in diameter has a Stainless steel lid secured by 12 bolts. It is fitted with a EPDM³ seal, 1 x 1.5" SS¹ cam lock and safety air feed, 1 x 2" SS¹ Vent assembly and 1 x 3" SS cam lock and dustcap for cleaning and filling. The outlet consists of a 50mm threaded outlet pipe in HDPE⁴ from the tank body to a 50mm GRPP⁵ lockable ball valve, fitted with EPDM³ seals and terminating in a 38mm integral camlock adaptor complete with dustcap. The dustcap is attached to the valve by a retaining cable



A reusable IBC for the transportation and pressurised discharge of liquids

Model shown is a painted PCM 250 with Label plates.



PCM 250 Product Range

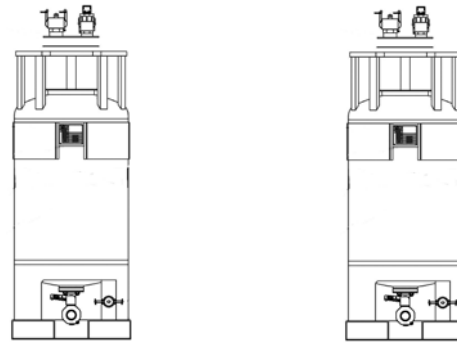

TYPE	250 Unlined	250 PE Lined
Capacity - L	250 L	250 L
Height - mm	1570	1570
Tare Weight - kg	123	141

PCM 250 Plan view

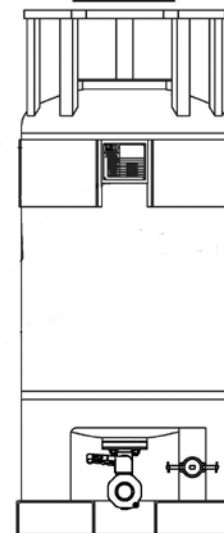
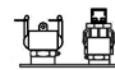
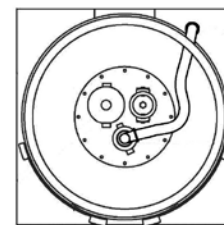

PCM 250 Front elevation



PCM 250 IBCs.

Whilst every attempt has been made to ensure that the information provided in this product information sheet is accurate and reliable Francis Ward cannot accept responsibility for the interpretation of the information provided. It is the responsibility of the user to determine the chemical compatibility of the container with its intended contents.



Francis Ward – A Division of The Rotational Mouldings Group

Brook House, 221 Bowling Back Lane, Bradford, BD4 8SJ, UK

Tel: +44 (0)1274 707030 | Fax: +44 (0)1274 724704 | Email: sales@francisward.com | Web: www.francisward.com